

**Entry to the Burrell Collection is free.
Donations in the boxes at the entrance
are very welcome.**

Please ask a gallery assistant if you have any queries during your visit.
We hope you enjoy the Collection and look forward to seeing you again.

Visitor Information

Opening Hours

Monday to Thursday and Saturday

10.00am–5.00pm

Friday and Sunday 11.00am–5.00pm

Facilities

Free guided tours; lifts; shop; restaurant;
coffee shop; espresso bar; picnic areas;
quiet space; changing place; accessible,
female, male, and all gender toilets; bicycle
parking; pay and display car parking; blue
badge parking; and coach parking.

Transport

By rail 15 minutes' walk from Pollokshaws
West rail station

By shuttle bus A free shuttle bus takes
visitors between Pollokshaws West
Station, Pollok House and the Burrell
Collection on a circular route. The bus
operates daily 9.30am–6.30pm.

By bus First Bus 57, 57A, McGill's 3
all stop opposite the Pollokshaws Road
entrance to Pollok Country Park. First Bus
34A stops on Dumbreck Road near the
Hags Road entrance to the park.

Use the Bloomberg
Connects app to explore
the Burrell Collection

**Bloomberg
Connects**



To find out more about the Burrell Collection objects, and other works
in the City's collection, visit <https://collections.glasgowmuseums.com>
and burrellcollection.com

Pollok Country Park 2060 Pollokshaws Road, Glasgow, G43 1AT Phone 0141 287 2550

The Burrell Collection

Floor plan and visitor information FREE



Ground Floor

Facilities

- Enquiry Desk
- Emergency Exit
- Female Toilets
- Disabled Access / Toilets
- Shop
- Lifts
- Male Toilets
- Baby Changing
- Restaurant
- Hearing System
- All Gender Toilets
- Changing Place



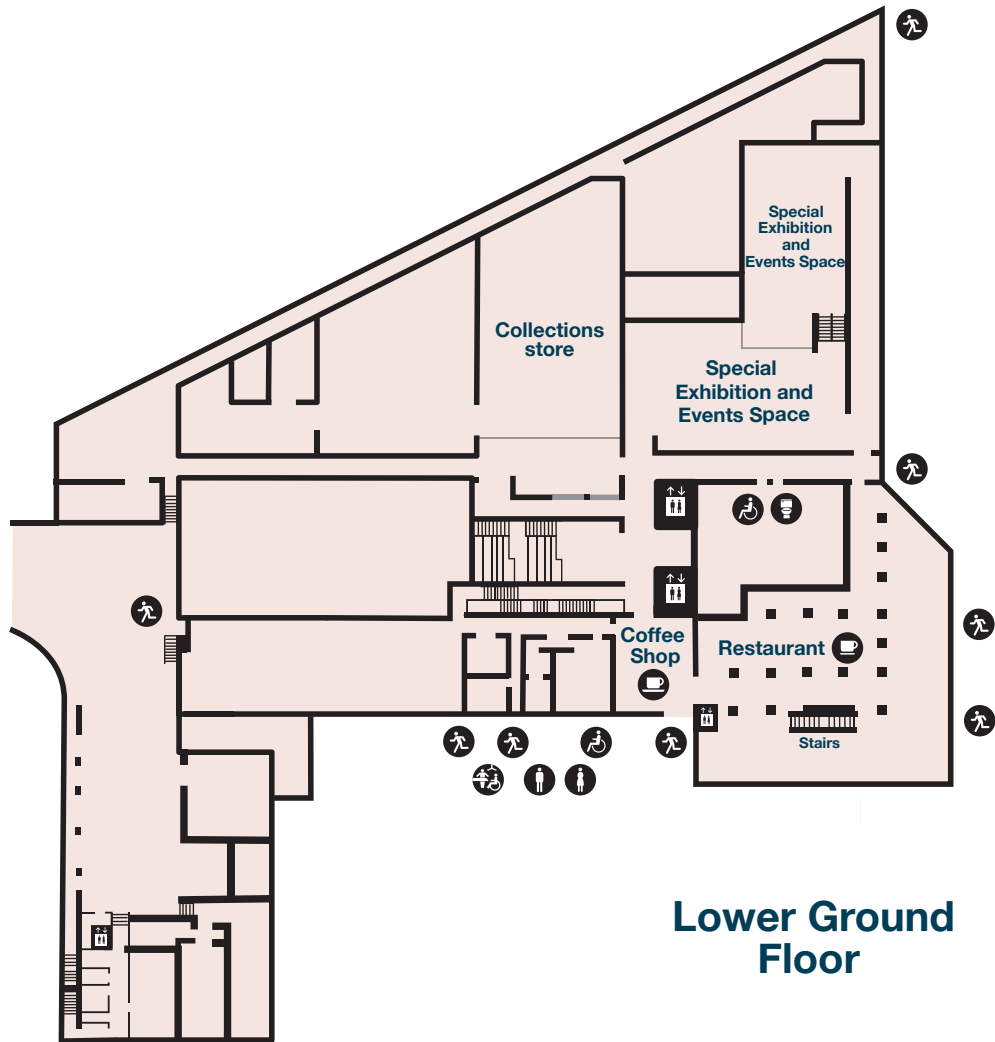

Facilities

- | | | | |
|--------------|----------------|--------------------|---------------------------|
| Enquiry Desk | Emergency Exit | Female Toilets | Disabled Access / Toilets |
| Shop | Lifts | Male Toilets | Baby Changing |
| Restaurant | Hearing System | All Gender Toilets | Changing Place |

Second Floor

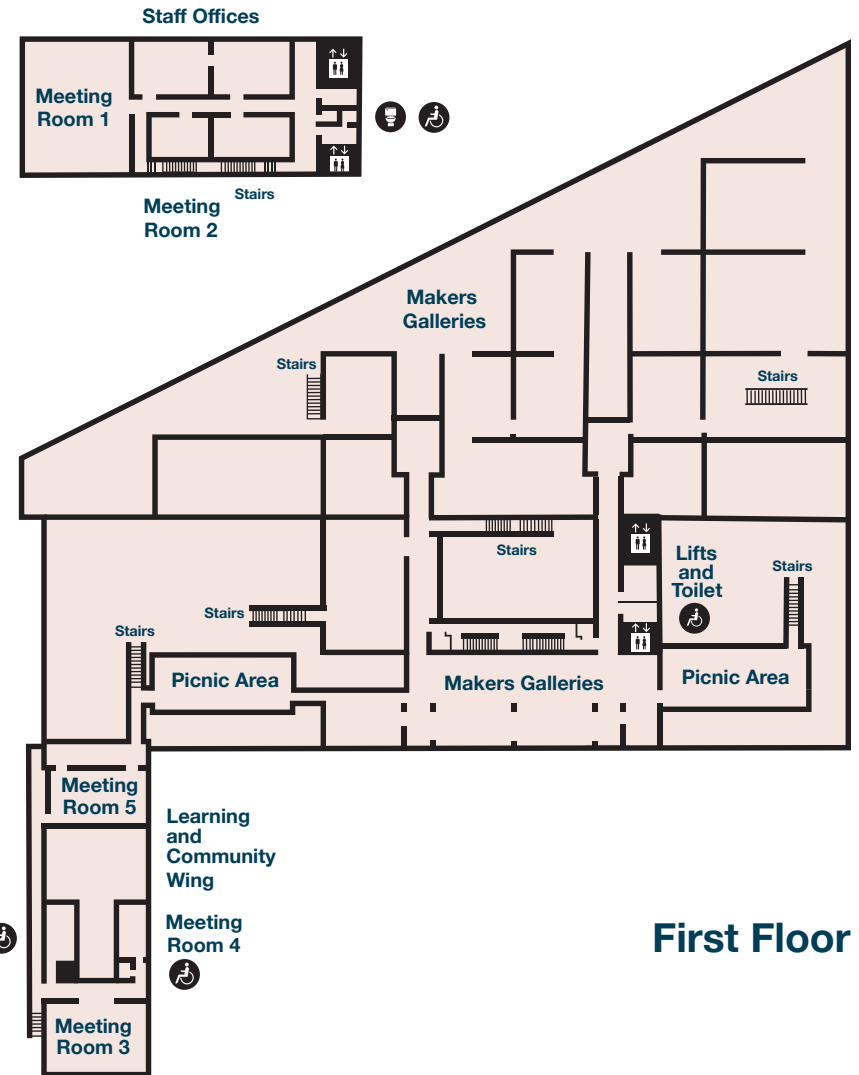

Facilities

- | | | | |
|--------------|----------------|--------------------|---------------------------|
| Enquiry Desk | Emergency Exit | Female Toilets | Disabled Access / Toilets |
| Shop | Lifts | Male Toilets | Baby Changing |
| Restaurant | Hearing System | All Gender Toilets | Changing Place |

First Floor